

T049900-350
341 PARTSBOOK
EA

Q728

16

39

127
ED

1

08/02/79
1462944

1

4



Spare Parts Catalogue

PFAFF 341

PFAFF INDUSTRIEMASCHINEN GMBH KAISERSLAUTERN

Preface

This parts catalogue contains head parts, arm parts, bedplate parts and accessories for the PFAFF 341-6 as well as organizational parts for the PFAFF 341-4 and obsolete parts.

Parts which differ according to the model (A; B or C), such as take-up lever, sewing hook, etc., are compiled in tables on pages 4 and 5.

As far as feasible, the component parts illustrated are arranged according to their disposition in the machine.

The underlined part numbers signify assemblies which are made up of component parts.

A numerical index of all parts listed is included on the last pages. This index lists also the respective illustration page numbers.

For special subclass organizations, such as feed dogs, needle plates, etc., which are not listed in this catalogue, please refer to the Attachments Catalogue.

Part number changes will be published on correction sheets.

All rights reserved.

July 1959

PFAFF INDUSTRIEMASCHINEN GMBH
KAISERSLAUTERN

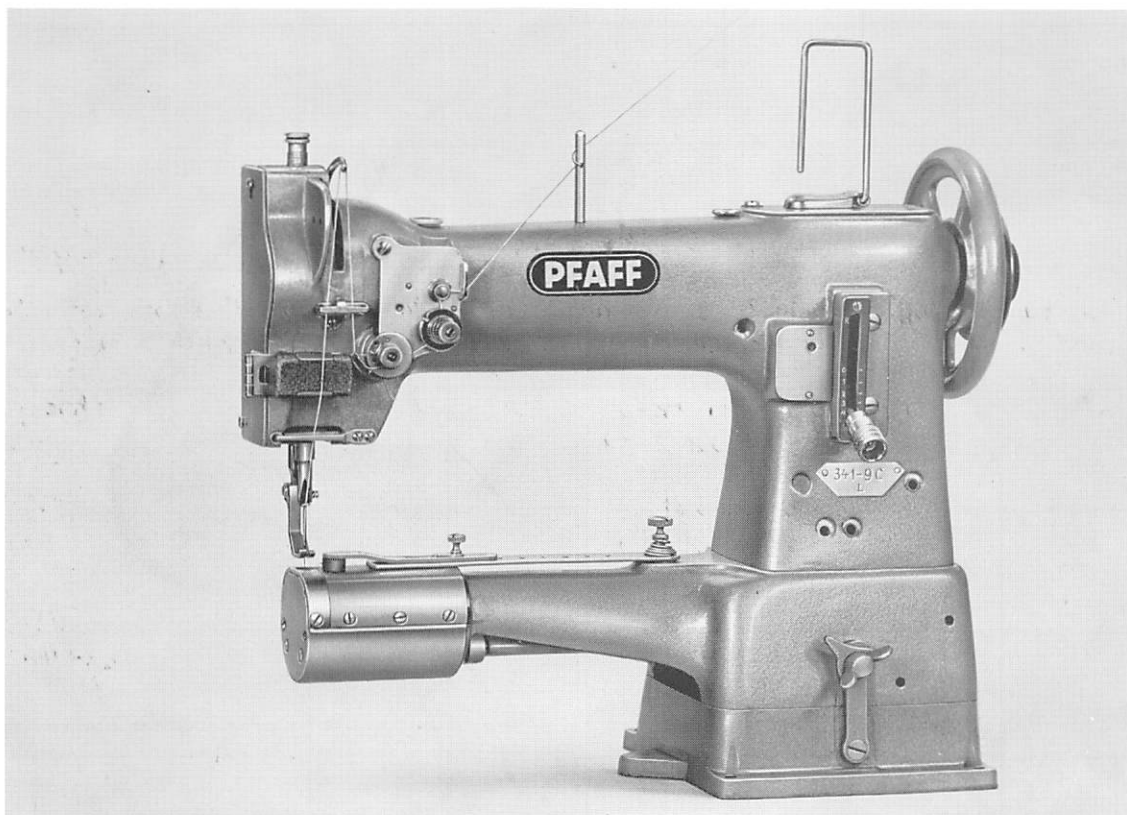

Single-Needle Cylinder-Bed Sewing Machines

PFAFF 341-6

Single-needle, cylinder-bed sewing machine organized with compound feed, bevel-gear-driven vertical rotary hook, sleeve take-up, mechanical tension release and spring-return feed regulator. Machine has balance wheel arranged on right-hand side and sews forward and reverse.

PFAFF 341-4

Same as PFAFF 341-6, but organized with roller presser.

Component Parts of the PFAFF 341 in Models A, B and C

| Part Name | Model | Part No. |
|----------------------------|-------|--|
| Needle bar | A, B | 710484 |
| | C | 709310 with Nos. 5024; 700226 |
| Take-up lever, complete | A, B | 9365 (fabric) 9367 (leather, rubber) |
| | C | 9366 (fabric) 9368 (leather, rubber) |
| Take-up lever | A, B | 9325 (fabric) 11755 (leather, rubber) |
| | C | 9326 (fabric) 10942 (leather, rubber) |
| Take-up lever driving stud | A, B | 8009 |
| | C | 15527 |
| Presser bar spring | A, B | 6525 |
| | C | 10633 |
| Presser bar lifter | A, B | 10734 |
| | C | 10888 |
| Tension release plunger | A, B | 10729 |
| | C | 10743 |
| Thread tension, complete | A, B | 9328 |
| | C | 9652 |
| Tension spring | A, B | 10183 |
| | C | 10184 |
| Thread check spring | A, B | 10023 |
| | C | 10937 |
| Thread guide, complete | A, B | 9394 |
| | C | 10027 10028 |
| Balance wheel, complete | A, B | 10133 |
| | C | 10172 |
| Balance wheel | A, B | 9005 |
| | C | 9014 |
| Lifting lever components | A, B | see p. 21 |
| | C | see p. 21 |

Component Parts of the PFAFF 341 in Models A, B and C

| Part Name | Model | Part No. |
|----------------------------------|--------------|---|
| Hook, with bobbin case, complete | A, B | 14192 (fabric) 13778 (leather, rubber) |
| | C | 13778 (fabric) 13786 (leather, rubber) |
| Hook, complete | A, B | 14191 (fabric) 13773 (leather, rubber) |
| | C | 13773 (fabric) 13785 (leather, rubber) |
| Hook | A, B | 14190 (fabric) 13772 (leather, rubber) |
| | C | 13772 (fabric) 13772 (leather, rubber) |
| Hook gib | A, B | 10178 (fabric) 10178 (leather, rubber) |
| | C | 10178 (fabric) 10848 (leather, rubber) |
| Bobbin case, complete | A, B | 10160 D |
| | C | 10160 D |
| Bobbin case base, complete | A, B | 10157 D |
| | C | 10157 D |
| Bobbin case cap, complete | A, B | 10159 |
| | C | 10159 |
| Hook washer | A, B | 10167 (fabric) 10167 (leather, rubber) |
| | C | 10167 (fabric) 10853 (leather, rubber) |

Head Parts

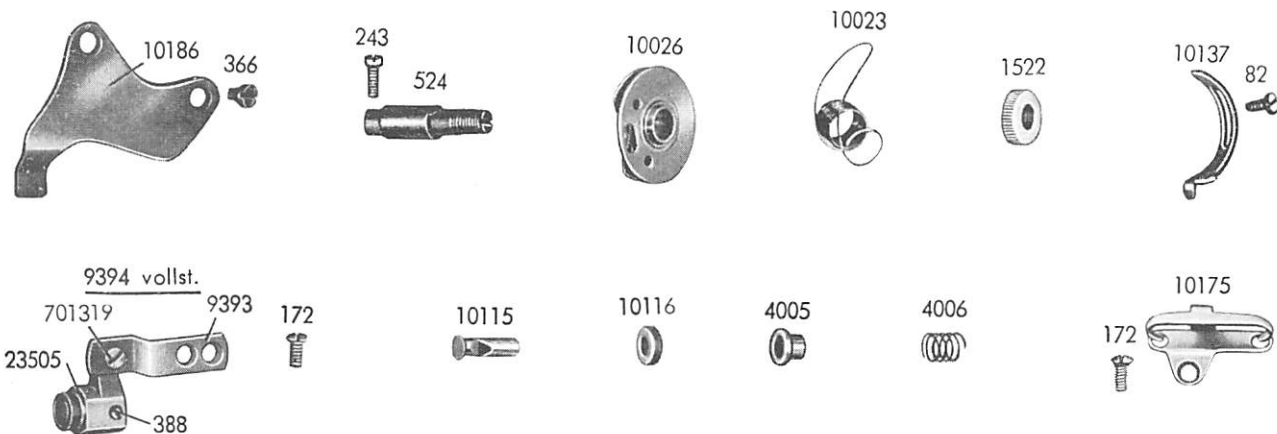
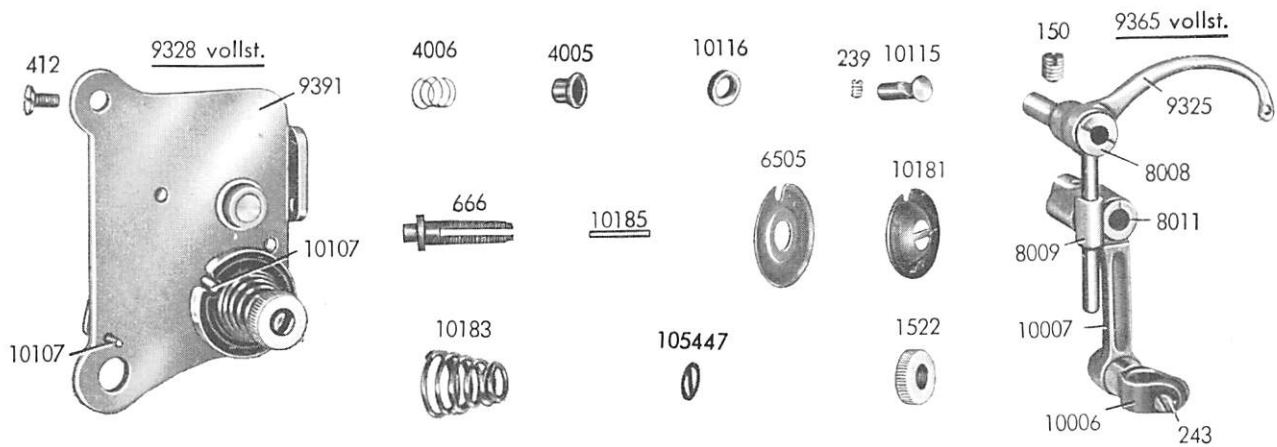
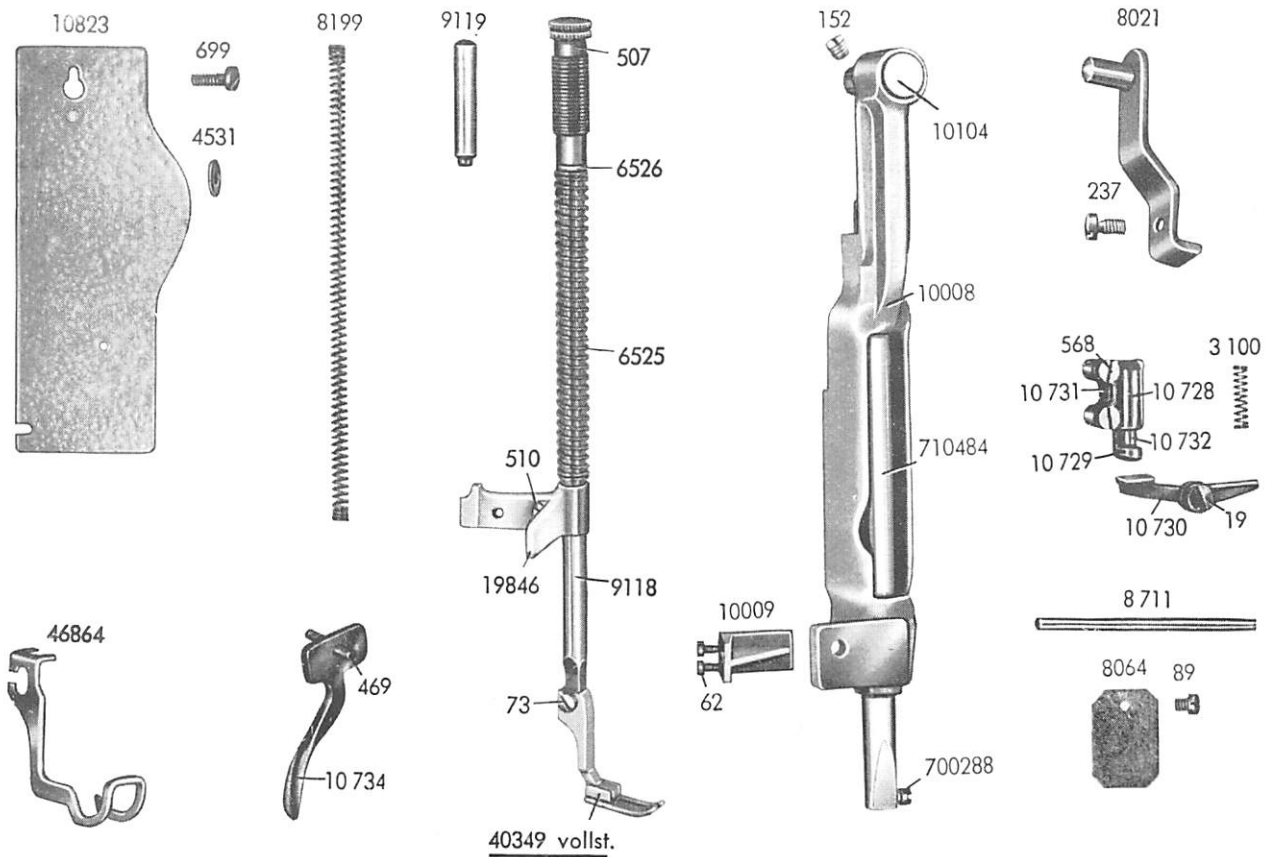

- 19 Hinge screw for No. 10730
- 62 Fastening screw for No. 10009
- 73 Fastening screw for Nos. 40349; 46864
- 82 Fastening screw for No. 10137
- 89 Fastening screw for No. 8064
- 150 Fastening screw for No. 8008
- 152 Fastening screw for No. 10104
- 172 Fastening screw for Nos. 9394; 10175
- 237 Fastening screw for No. 8021
- 239 Fastening screw for No. 10115
- 243 Fastening screw for No. 524 and binding screw for No. 10006
- ★ 700288 Needle set screw
- 366 Fastening screw for No. 10186
- 388 Fastening screw for No. 10115
- 412 Fastening screw for No. 9328
- 469 Hinge screw for No. 10734
- 507 Pressure regulating screw
- 510 Fastening screw for No. 19846
- 524 Tension stud, lower
- ★ 568 Fastening screw for Nos. 10728; 10731
- 666 Tension stud, upper
- ★ 699 Fastening screw for No. 10823
- 701319 Fastening screw for No. 9393
- 1522 Nut for Nos. 524; 666
- 3100 Pressure spring for No. 10732
- 4005 Thread retainer sleeve for Nos. 9328; 9394
- 4006 Pressure spring for No. 4005
- 4531 Washer for No. 699
- 6505 Tension disc
- 6525 Presser bar spring, outer (Models A & B)
- 6526 Washer for No. 6525
- 8008 Hinge stud for No. 9325
- 8009 Driving stud for No. 9325 (Models A & B)
- 8011 Hinge stud for No. 10007
- 8021 Lifting bracket link for No. 19846
- 8064 Oil pad for No. 9365
- 8199 Presser bar spring, inner
- ★ 8711 Tension release plunger for No. 9328
- 9118 Presser bar
- 9119 Presser bar spring stop pin for No. 8199
- 9325 Take-up lever (Models A & B; fabric)
- 9328 Thread tension (Models A & B), complete, consisting of Nos. 239; 366; 666; 1522; 4005; 4006; 6505; 9391; 10107; 10115; 10116; 10181; 10183; 10185; 10186; 105447
- 9365 Take-up lever (Models A & B; fabric), compl., consisting of Nos. 243; 8008; 8009; 8011; 9325; 10006; 10007
- 9391 Tension bracket
- 9393 Thread retainer bracket
- 9394 Thread retainer (Models A & B), complete, consisting of Nos. 388; 701319; 4005; 4006; 9393; 10115; 10116; 23505
- 10006 Needle bar connecting stud
- 10007 Needle bar connecting link
- 10008 Needle bar frame
- 10009 Position bracket for No. 10008
- 10023 Thread check spring (Models A & B)
- 10026 Thread controller disc
- 10104 Hinge stud for No. 10008
- 10107 Position pin for Nos. 6505; 10026
- 10115 Thread retainer stud for Nos. 9328; 9394
- 10116 Thread retainer stud collar for Nos. 9328; 9394
- 10137 Stop for No. 10023
- 10175 Thread guide
- 10181 Tension release washer
- 10183 Tension spring (Models A & B)
- 10185 Tension release pin
- 10186 Tension release plate
- 710484 Needle bar (Models A & B)
- 10728 Pressure spring receptacle for No. 10731
- 10729 Tension release plunger for No. 10728 (Models A & B)
- 10730 Tension release lever for No. 10729
- ★ 10731 Lifting bracket guide for No. 19846
- 10732 Pin, spring-loaded, for No. 3100
- ★ 10734 Presser bar lifter (Models A & B); for high lift: No. 10735
- 10823 Face plate
- ★ 19846 Presser bar lifting bracket
- 23505 Thread retainer sleeve bracket for No. 9394
- 40349 Presser foot, hinged, complete, consisting of
No. 26497 Shoe
No. 26612 Shank
w/o No. Hinge pin
- 46864 Finger guard
- 105447 Washer for No. 10183

Arm Parts

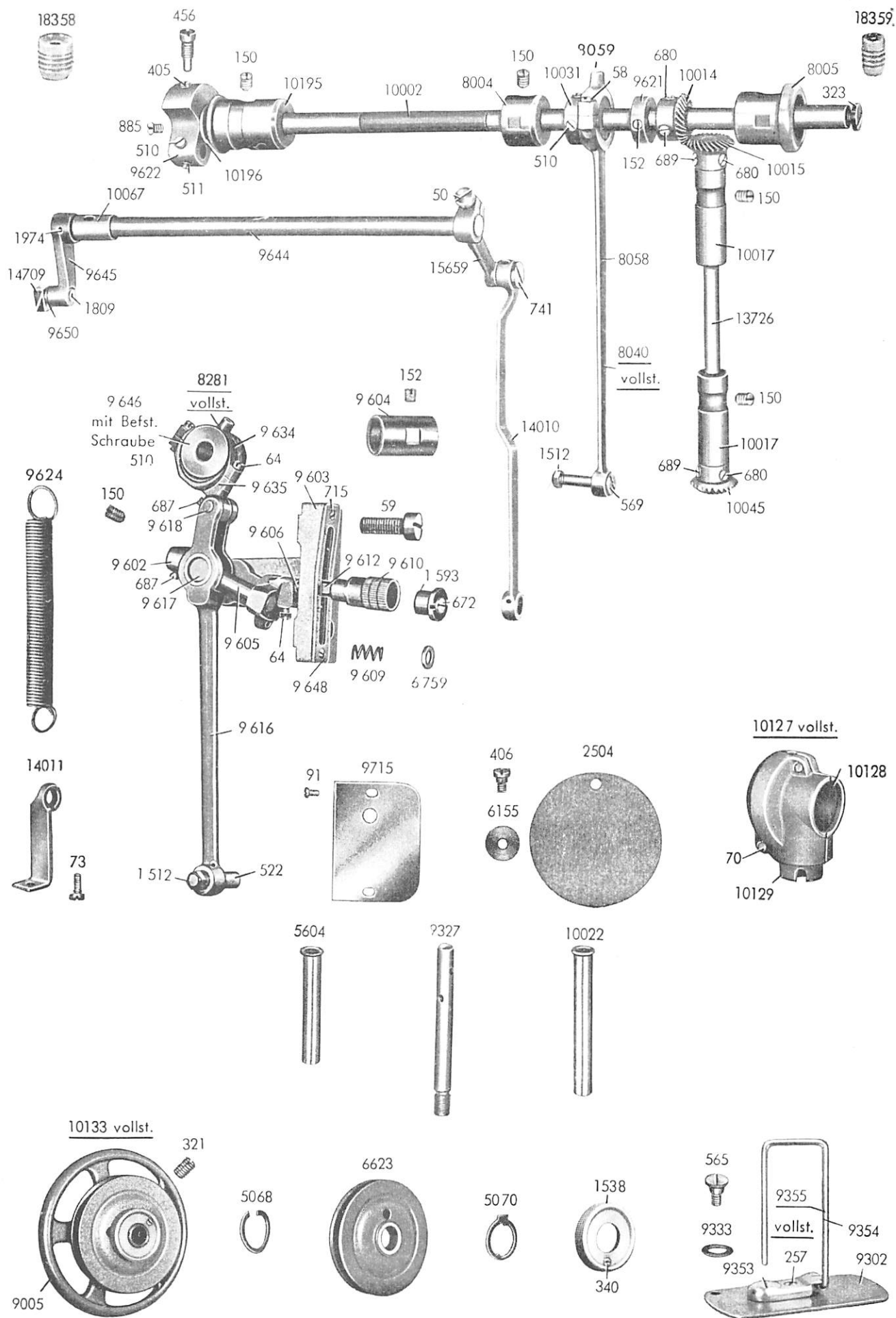

- 50 Binding screw for No. 15659
- 58 Fastening screw for No. 8059
- * 59 Fastening screw for No. 9603
- * 64 Fastening screw for Nos. 9606; 9634
- 70 Fastening screw for No. 10127
- 73 Fastening screw for No. 14011
- 91 Fastening screw for No. 9715
- 150 Fastening screw for Nos. 8004; 10017; 10195 and end screw for No. 9605
- 152 Fastening screw for Nos. 9604; 9621
- 257 Fastening screw for No. 9355
- 321 Fastening screw for No. 10133
- 323 End screw, rear, for No. 10002
- 340 Stop screw for No. 1538
- 405 Fastening screw for No. 9622
- * 406 Fastening screw for No. 2504
- * 456 Fastening screw for No. 9622
- 510 Fastening screw for Nos. 9646; 10031 and for No. 8011 (see Section I)
- 511 Fastening screw for No. 8011 (see Section I)
- 522 Hinge screw for Nos. 9616; 14010
- 565 Fastening screw for No. 9302
- 569 Hinge screw for No. 8040
- 672 End screw for No. 1593
- 680 Fastening screw, pointed, for Nos. 10014; 10015; 10045
- 687 Fastening screw for Nos. 9605; 9618
- 689 Fastening screw, blunt, for Nos. 10014; 10015; 10045
- * 715 Fastening screw for No. 9648
- 741 Hinge screw for Nos. 14010; 15659
- * 885 End screw, front, for No. 10002
- 1512 Nut for Nos. 522; 569
- 1538 Stop motion nut for No. 6623
- 1593 Nut for No. 9609
- 1809 Slide block stud for No. 9645
- * 1974 Positioning pin for No. 9645
- 2504 Arm cover, rear
- 5068 Spring washer for No. 6623
- 5070 Balance wheel friction washer for No. 6623
- 5604 Oil tube, 2" long, for No. 10017
- * 6155 Spring washer for No. 406
- 6623 Pulley for No. 9005
- 6759 Washer for No. 9609
- 8004 Arm shaft bushing, center
- * 8005 Arm shaft bushing, rear, with oil wick No. 6617
- 8040 Feed lifting connection, complete, consisting of Nos. 58; 8058; 8059
- 8058 Feed lifting connection
- 8059 Feed lifting connection cap
- 8281 Feed driving eccentric sleeve, complete, consisting of Nos. 64; 9634; 9635; 9646; for long stitch: No. 8280, complete
- 9005 Balance wheel (Models A & B)
- 9302 Top cover
- 9327 Thread guide
- 9333 Spring washer for No. 565
- 9353 Spool holder base for No. 9354
- 9354 Spool holder wire for No. 9353
- 9355 Spool holder, complete, consisting of Nos. 9353; 9354
- 9602 Feed regulator
- 9603 Feed regulator bearing bracket
- 9604 Feed regulator bearing bracket bushing
- 9605 Feed regulator stud
- 9606 Feed regulator lever stud
- 9609 Retaining spring for No. 9610
- 9610 Feed regulator knob
- 9612 Feed regulator lever stud guide
- 9616 Feed driving connection
- 9617 Feed regulator hinge stud
- 9618 Hinge stud for Nos. 9616; 8281
- 9621 Collar for No. 10127
- 9622 Needle bar crank
- 9624 Tension spring for No. 9602
- 9634 Feed driving connection cap
- 9635 Feed driving eccentric sleeve
- 9644 Needle bar frame shaft
- 9645 Needle bar frame shaft crank, front
- 9646 Feed driving eccentric
- * 9648 Feed regulator index plate
- 9650 Washer for No. 14709
- * 9715 Arm cover, front
- 10002 Arm shaft
- 10014 Arm shaft bevel gear
- 10015 Vertical shaft bevel gear, upper
- 10017 Vertical shaft bushing, upper and lower
- 10022 Oil tube, 2 1/4" long, for No. 11511 (see Section III)
- 10031 Feed lifting eccentric
- 10045 Vertical shaft bevel gear, lower
- 10067 Needle bar frame shaft bushing
- 10127 Bevel gear case, complete, consisting of Nos. 70; 10128; 10129
- 10128 Bevel gear case section for No. 10127
- 10129 Bevel gear case section, with threaded borehole, for No. 10127
- 10133 Balance wheel (Models A & B), complete, consisting of Nos. 321; 340; 1538; 5068; 5070; 6623; 9005
- 10195 Arm shaft bushing, front, with oil wick No. 10198
- 10196 Friction washer for No. 10195
- 13726 Vertical shaft
- 14010 Needle bar frame shaft connection
- 14011 Spring suspension bracket for No. 9624
- * 14709 Slide block for No. 1809
- 15659 Needle bar frame shaft crank, rear, for Nos. 9644; 14010
- * 18358 Oil cup, front, for No. 10195
- * 18359 Oil cup, rear, for No. 8004
- 29093 Model plate (not ill.)
- 29140 Positioning pin for No. 29093 (not ill.)
- 10001 Arm (not ill.)



Bed Plate Parts

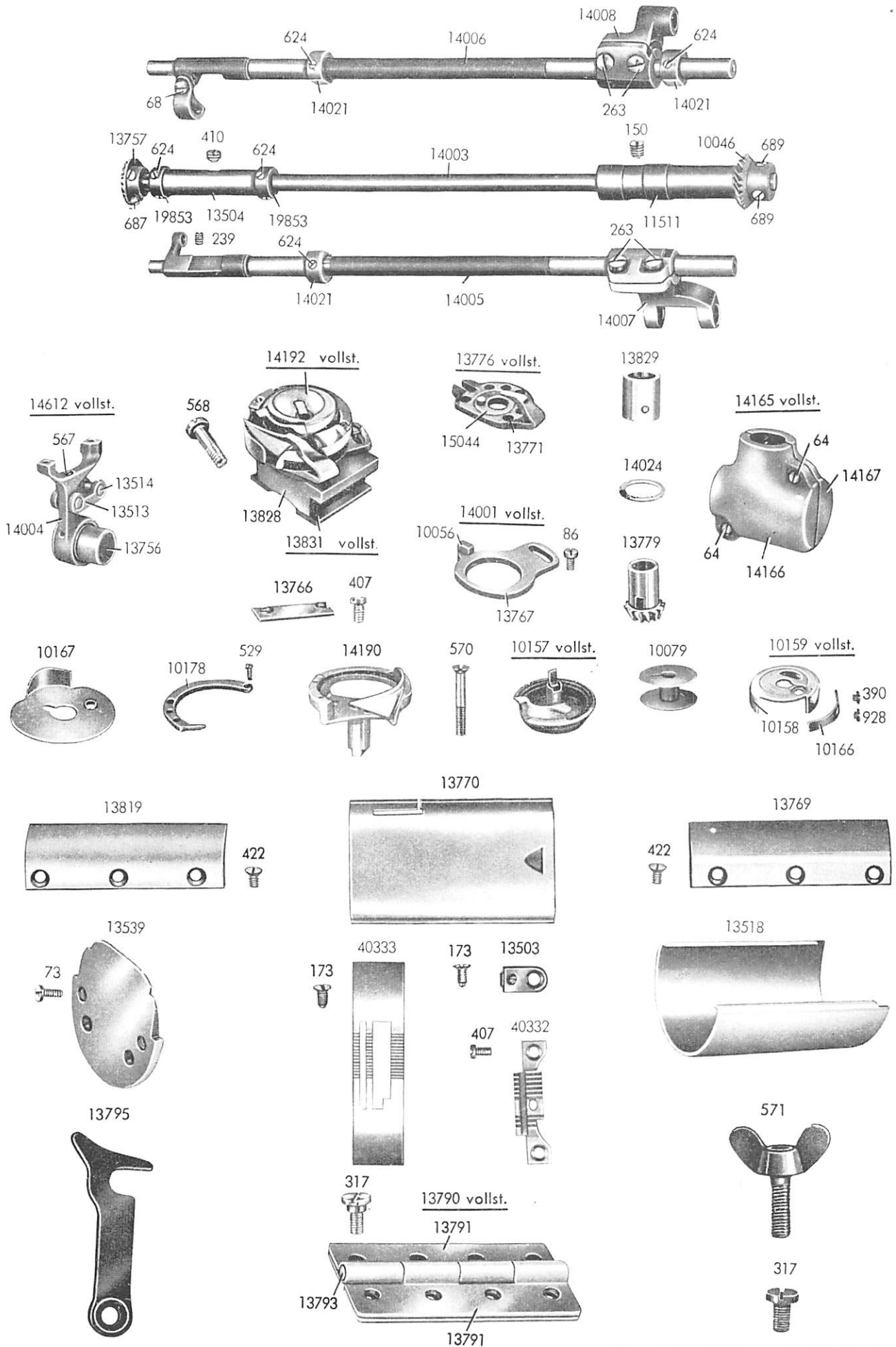

- 64 Fastening screw for No. 14165
- 68 Binding screw for No. 14006
- ★ 73 Fastening screw for No. 13539
- ★ 86 Fastening screw for No. 14001
- 150 Fastening screw for No. 11511
- 173 Fastening screw for Nos. 13503; 40333
- 239 Fastening screw for No. 13514
- 263 Binding screw for Nos. 14007; 14008
- 317 Fastening screw for Nos. 13790; 13795
- 390 Fastening screw for No. 10166
- 407 Fastening screw for Nos. 13766; 40332
- 410 Fastening screw for No. 13504
- 422 Fastening screw for Nos. 13769; 13819
- 529 Fastening screw for No. 10178
- 567 Fastening screw for No. 13514
- 568 Fastening screw for No. 13831
- 570 Fastening screw for No. 14190
- 571 Wing screw for No. 13795
- ★ 624 Fastening screw for Nos. 14021; 19853
- ★ 687 Fastening screw for No. 13757
- 689 Fastening screw for No. 10046
- 928 Regulating screw for No. 10166
- 10046 Hook drive shaft bevel gear, rear
- 10056 Bobbin case lever slide for No. 13767
- 10079 Bobbin
- 10157 Bobbin case base, complete, consisting of
 - No. 10070 Latch
 - No. 10071 Hinge pin for No. 10070
 - No. 10072 Pressure spring for No. 10073
 - No. 10073 Plunger
 - No. 10156 Bobbin case base
- 10158 Bobbin case cap
- 10159 Bobbin case cap, complete, consisting of Nos. 390; 928; 10158; 10166
- 10166 Tension spring for No. 10158
- 10167 Hook washer for No. 14192
- 10178 Hook gib
- 11511 Hook drive shaft bushing, rear
- 13503 Needle plate bracket
- 13504 Hook drive shaft bushing, front
- 13513 Feed driving link
- 13514 Hinge stud for No. 13513
- ★ 13518 Cylinder arm cap
- ★ 13539 Shaft bearing plate for Nos. 14005; 14006
- 13756 Feed bar bushing
- 13757 Hook drive shaft bevel gear, front
- 13766 Position bracket for No. 13828
- 13767 Bobbin case lever fulcrum for No. 14001
- 13769 Bed slide clamp plate, front, for No. 13770
- 13770 Bed slide
- 13771 Bobbin case lever
- 13776 Bobbin case opener, complete, consisting of Nos. 13771; 15044
- 13779 Hook shaft bevel gear
- 13790 Bed hinge, complete, consisting of Nos. 13791; 13793
- 13791 Hinge leaf
- 13793 Hinge stud for No. 13791
- 13795 Catch
- 13819 Bed slide clamp plate, rear, for No. 13770
- 13828 Hook saddle
- ★ 13829 Hook bearing bushing
- ★ 13831 Hook saddle, complete, consisting of Nos. 86; 407; 687; 13757; 13766; 13779; 13828; 13829; 14001, complete
- 14001 Bobbin case lever fulcrum, complete, consisting of Nos. 10056; 13767
- 14003 Hook drive shaft
- 14004 Feed bar
- 14005 Feed rock shaft
- 14006 Feed lifting shaft
- 14007 Feed rock shaft crank
- 14008 Feed lifting shaft crank
- 14021 Set collar for Nos. 14005; 14006
- ★ 14024 Spacing washer, .027 inch, for No. 13779 or No. 14025, .029 inch (optional)
- 14165 Bevel gear case, rear, complete, consisting of Nos. 64; 14166; 14167
- 14166 Bevel gear case section
- 14167 Bevel gear case section, with threaded borehole
- 14190 Hook for No. 14192
- 14192 Hook, with bobbin case, complete, consisting of Nos. 529; 10157, complete; 10159, complete; 10167; 10178; 14190
- 14612 Feed bar, complete, consisting of Nos. 567; 13513; 13514; 13756; 14004
- 15044 Bobbin case lever eccentric, with driving pin No. 10088
- ★ 19853 Set collar for No. 14003
- 40332 Feed dog, sawtooth cut
- 40333 Needle plate
- 14002 Cylinder arm, with 4 arm screws No. 352 and 2 dowel pins No. 6531 (not ill.)
- 14200 Machine base (not ill.)

Organizational Parts

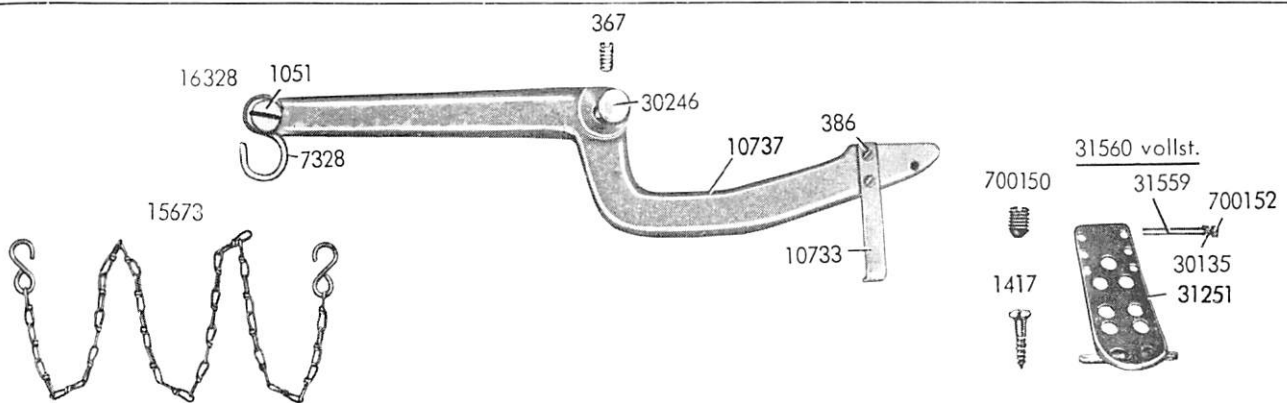
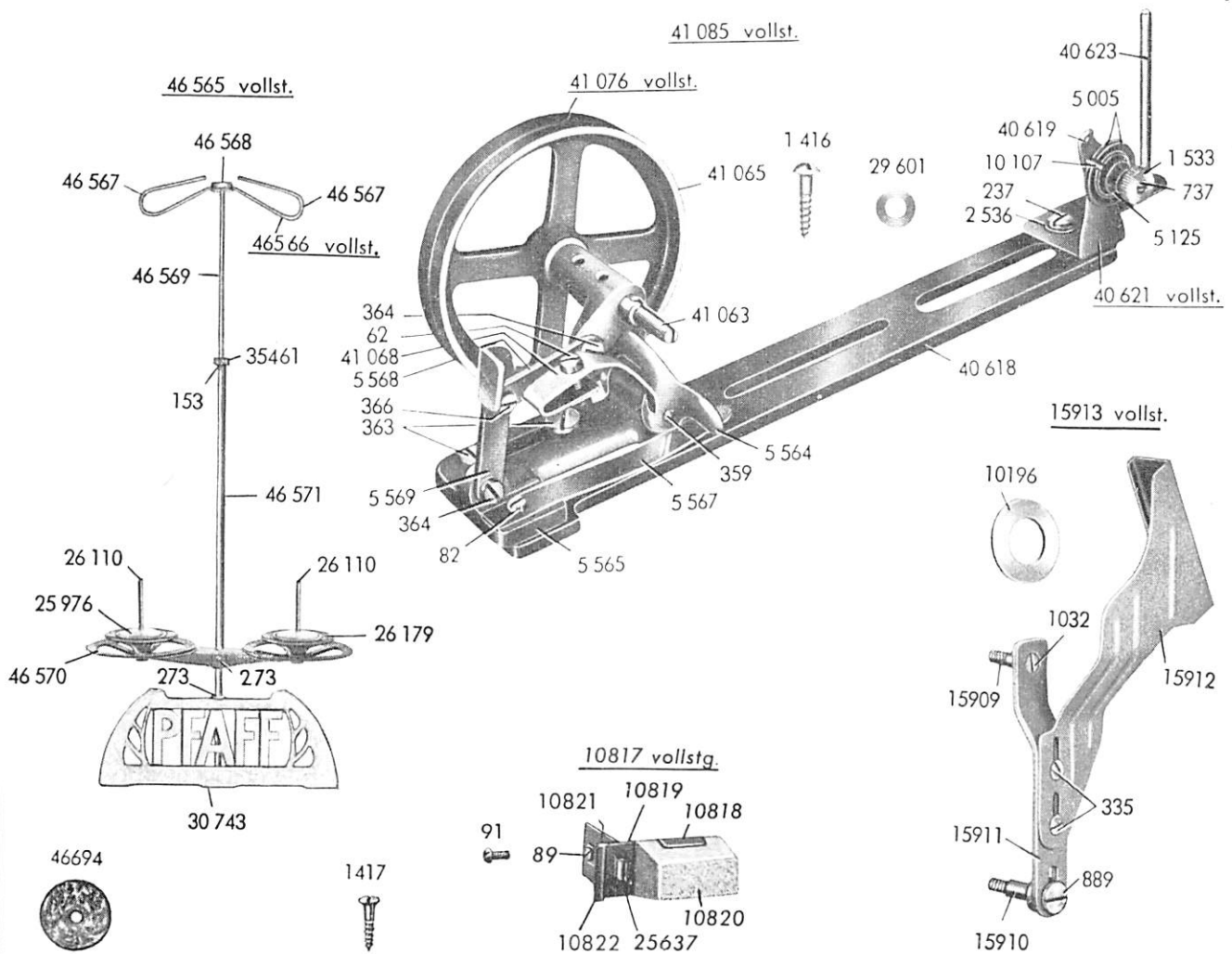

| | | | |
|-------|--|-------|--|
| 62 | Set screw for No. 41068 | 15913 | Belt guard, complete, consisting of Nos. 335; 889; 1032; 10196; 15909; 15910; 15911; 15912 |
| 82 | Fastening screw for No. 5567 | 25637 | Leaf spring for No. 10821 |
| 89 | Fastening screw for No. 10817 | 25976 | Spool cap for No. 26179 (on special request) |
| 91 | Fastening screw for No. 10818 | 26110 | Spool pin |
| 153 | Fastening screw for No. 35461 | 26179 | Spool disc |
| 237 | Fastening screw for No. 40621 | 29601 | Washer for No. 1416 |
| 273 | Fastening screw for Nos. 46571; 46570 | 30743 | Thread unwinder base |
| 335 | Fastening screw for No. 15912 | 35461 | Set collar for No. 46571 |
| 359 | Hinge screw for Nos. 5564; 5565 | 40618 | Bobbin winder base for No. 41076 |
| 363 | Fastening screw for No. 41076 | 40619 | Bobbin winder tension bracket for No. 40621 |
| 364 | Fastening screw for Nos. 5568; 5569 | 40621 | Thread tension, complete, consisting of Nos. 737; 1533; 5005; 5125; 10107; 40619; 40623 |
| 366 | Hinge screw for Nos. 5568; 5569 | 40623 | Spool pin |
| 737 | Tension stud for No. 40621 | 41063 | Bobbin winder spindle |
| 889 | Fastening screw, lower, for No. 15911 | 41065 | Bobbin winder pulley |
| 1032 | Fastening screw, upper, for No. 15911 | 41068 | Bobbin winder stop latch |
| 1416 | Wood screw for No. 41085 | 41076 | Bobbin winder, complete, consisting of Nos. 62; 82; 359; 364; 366; 5564; 5565; 5567; 5568; 5569; 41063; 41065; 41068 |
| 1417 | Wood screw for No. 46565 | 41085 | Bobbin winder, table model, complete, consisting of Nos. 237; 363; 2536; 40618; 40621, complete; 41076, complete |
| 1533 | Nut for No. 737 | 46565 | Thread unwinder, complete, consisting of Nos. 153; 273; 26110; 26179; 30743; 35461; 46566, complete; 46570; 46571; 46694 |
| 2536 | Washer for No. 237 | 46566 | Thread guide, complete, consisting of Nos. 46567; 46568; 46569 |
| 5005 | Tension disc | 46567 | Thread guide wire |
| 5125 | Tension spring | 46568 | Thread guide position cup |
| 5564 | Bobbin winder frame | 46569 | Thread guide rod for No. 46573 |
| 5565 | Bobbin winder frame base | 46570 | Spool rest |
| 5567 | Bobbin winder frame spring | 46571 | Spool rest rod |
| 5568 | Bobbin winder stop latch trip lever for Nos. 5564; 5569 | 46694 | Spool pin washer (foam rubber) for Nos. 26179 |
| 5569 | Bobbin winder thumb lever for No. 5568 | | |
| 10107 | Position pin for No. 5005 | | |
| 10196 | Friction washer for No. 8005 (optional) | | |
| 10817 | Thread lubricator, complete, consisting of Nos. 89; 91; 10818; 10819; 10820; 10821; 10822; 25637 | | |
| 10818 | Oil pad holder | | |
| 10819 | Hinge leaf for No. 10817 | | |
| 10820 | Oil pad for No. 10818 | | |
| 10821 | Hinge leaf for No. 10817 | | |
| 10822 | Hinge pin for No. 10821 | | |
| 15909 | Stud, threaded, upper, for No. 15911 | | |
| 15910 | Stud, threaded, lower, for No. 15911 | | |
| 15911 | Belt guard bracket | | |
| 15912 | Belt guard | | |

Organizational Parts for Foot-Operated Presser Bar Lifter (Models A & B)

| | | | |
|---------|---|-------|---|
| 700150 | Fastening screw for No. 31559 | 15673 | Chain for Nos. 10737; 31560 |
| 700152 | Fastening screw for No. 30135 | 16328 | Slip washer for No. 1051 |
| 367 | Fastening screw for No. 30246 | 30135 | Set collar for No. 31559 |
| 386 | Fastening screw for No. 10733 | 30246 | Hinge stud for No. 10737 |
| 1051 | Chain suspension screw for No. 7328 | 31251 | Treadle, narrow, for No. 31560 |
| 1417 | Wood screw for No. 31560 | 31559 | Chain suspension stud for No. 31560 |
| 7328 | Chain suspension hook for No. 1051 | 31560 | Treadle, narrow, complete, consisting of Nos. 700150; 700152; 30135; 31251; 31559 |
| 10733 | Lifting lever lifting bracket for No. 10737 | | |
| ★ 10737 | Lifting lever | | |

Organizational Parts for Foot-Operated Presser Bar Lifter (Model C)

| | | | |
|--------|--------------------------------|-------|--|
| 58 | Fastening screw for No. 10617 | 17530 | Lifting lever connection, complete, for No. 14675, consisting of No. 17531 Connection No. 20346 Ball joint |
| 700150 | Fastening screw for No. 31559 | 30135 | Set collar for No. 31559 |
| 700152 | Fastening screw for No. 30135 | 30246 | Hinge stud for No. 14675 |
| 263 | Hinge screw for No. 17530 | 31251 | Treadle, narrow, for No. 31560 |
| 367 | Fastening screw for No. 30246 | 31559 | Chain suspension stud for No. 31560 |
| 1417 | Wood screw for No. 31560 | 31560 | Treadle, narrow, complete, consisting of Nos. 700150; 700152; 30135; 31251; 31559 |
| 10617 | Arm cover, rear | | |
| 14675 | Connection lever for No. 17530 | | |
| 15673 | Chain for Nos. 14675; 31560 | | |

V

**Organizational Parts
PFAFF 341-4
Obsolete Parts
PFAFF 341**

9119



61005



9367 vollst.

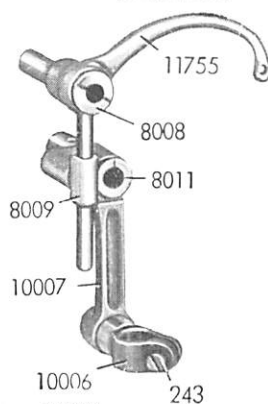

13778 vollst.



13772



10809



10167

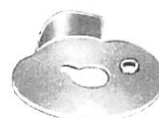

10178



529

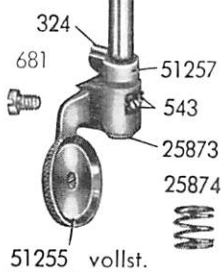

51255 vollst.

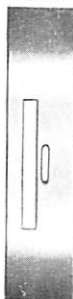
10006
44619

44618



10157 vollst.



10159 vollst.



390

928

10166

50



58



73



82



175



672



10963



9 626



785



336



509



407



2044



398

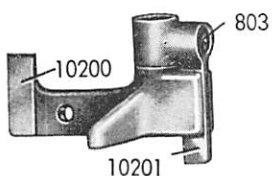

10106

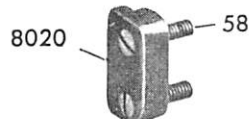

13520

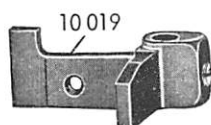
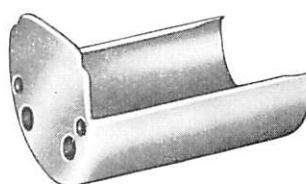

2279



9707

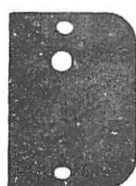

25872

13783 vollst.

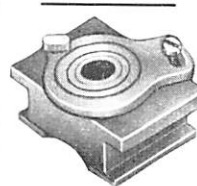

13781



10945



10197



13780



8035



2148



7371



82

6601



41 736 vollst.



10 705

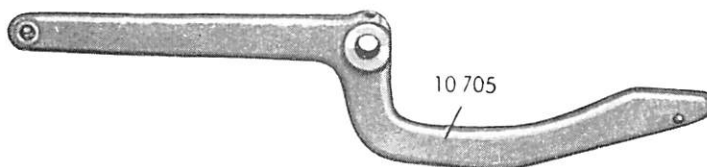

51157 vollst.



| | | | |
|--------|---|---------|--|
| 243 | Binding screw for No. 10006 | 10166 | Tension spring for No. 10158 |
| 324 | Stop screw for No. 51257 | 10167 | Hook washer for No. 13778 |
| 390 | Fastening screw for No. 10166 | 10178 | Hook gib |
| 529 | Fastening screw for No. 10178 | 10809 | Spacer, .016", for No. 51257 |
| 543 | Stop screw for No. 51257 and fastening screw for No. 25873 | | or: |
| 681 | Fastening screw for No. 51255 | | No. 10810 Spacer, .024" |
| 928 | Regulating screw for No. 10166 | | No. 10811 Spacer, .032" |
| 8008 | Hinge stud for No. 11755 | | No. 10812 Spacer, .039" |
| 8009 | Driving stud for No. 11755 (Models A & B) | | No. 10813 Spacer, .048" |
| 8011 | Hinge stud for No. 10007 | 11755 | Take-up lever (Models A & B; leather) |
| 9119 | Presser bar spring stop pin for No. 61005 | 13772 | Hook for No. 13778 |
| 9367 | Take-up lever (Models A & B; leather), complete, consisting of Nos. 243; 8008; 8009; 8011; 10006; 10007; 11755 | 13778 | Hook, with bobbin case, complete, consisting of Nos. 529; 10157, complete; 10159, complete; 10167; 10178; 13772 |
| * 9811 | Presser bar | 25873 | Spring stop for No. 51257 |
| 10006 | Needle bar connecting stud | 25874 | Pressure spring for No. 25873 |
| 10007 | Needle bar connecting link | 44618 | Feed dog, sawtooth cut |
| 10157 | Bobbin case base, complete, consisting of No. 10070 Latch No. 10071 Hinge pin for No. 10070 No. 10072 Pressure spring for No. 10073 No. 10073 Plunger No. 10156 Bobbin case base | 44619 | Needle plate for No. 44618 |
| 10158 | Bobbin case cap | * 51255 | Roller presser, swing-type, 3/16" wide, compl., consisting of No. 1027 Set screw for No. 1931 No. 1665 Nut for No. 1027 No. 1931 Roller presser, large No. 46187 Bearing needles, 16 ea No. 51253 Roller presser arm (optional) |
| 10159 | Bobbin case cap, complete, consisting of Nos. 390; 928; 10158; 10166 | * 51257 | Roller presser arm bracket |
| | | 61005 | Presser bar spring, inner |

Obsolete Parts

| | | | |
|------|--|-------|--|
| 50 | Fastening screw for No. 9603 (cannot be replaced) | 8019 | Presser bar lifter, standard; for high lift: No. 10139 (replaced by Nos. 10734; 10735) |
| 58 | Fastening screw for No. 8020 (replaced by No. 568) | 8020 | Lifting bracket guide for Nos. 10019; 10200 (replaced by No. 10731) |
| 58 | Fastening screw for No. 9634 (replaced by No. 64) | 8035 | Oil cup, rear, for No. 8004 (replaced by No. 18359) |
| 73 | Fastening screw for No. 10823 (replaced by No. 699) | 9626 | Feed regulator index plate (cannot be replaced) |
| 82 | Fastening screw for No. 7371 (cannot be replaced) | 9707 | Arm cover, front (replaced by No. 9715) |
| 82 | Fastening screw for No. 13767 (replaced by No. 86) | 10019 | Presser bar lifting bracket, standard; for high lift: No. 10170 (replaced by No. 19846) |
| 169 | Fastening screw for No. 13520 (cannot be replaced) | 10106 | Tension release plunger, standard, for No. 9328; for high lift: No. 10171 (replaced by No. 8711) |
| 175 | Fastening screw for No. 9626 (replaced by No. 715) | 10197 | Oil cup, front, for No. 10195 (cannot be replaced) |
| 336 | Needle set screw (cannot be replaced) | 10200 | Presser bar lifting bracket, standard; for high lift: No. 10208 (replaced by No. 19846) |
| 398 | Fastening screw for No. 9622 (replaced by No. 456) | 10201 | Presser bar guide collar for No. 10200 (cannot be replaced) |
| 407 | Fastening screw for No. 46571 (cannot be replaced) | 10705 | Lifting lever (replaced by No. 10737) |
| 509 | Fastening screw for No. 13757 (replaced by No. 687) | 10945 | Set collar for No. 13504 (replaced by No. 19853) |
| 672 | End screw, front, for No. 10002 (cannot be replaced) | 10963 | Presser bar (replaced by No. 9811) |
| 785 | Fastening screw for No. 10945 (cannot be replaced) | 13520 | Cylinder arm cap (replaced by Nos. 13518; 13539) |
| 803 | Fastening screw for No. 10201 (cannot be replaced) | 13780 | Spacer for No. 13779 (replaced by No. 14024) |
| 2044 | Positioning pin for No. 9645 (cannot be replaced) | 13781 | Hook bearing bushing (cannot be replaced) |
| 2148 | Spring washer for No. 2279 (replaced by No. 6155) | 13783 | Hook saddle, complete (replaced by No. 13831) |
| 2279 | Positioning pin for No. 2504 (cannot be replaced) | 25872 | Roller presser arm bracket (replaced by No. 51257) |
| 6601 | Slide block for No. 1809 (to be used only with needle bar frames with .386"-wide slide block slot) | 41736 | Roller presser, complete (replaced by No. 51157) |
| 7371 | Tension spring for No. 10705 (cannot be replaced) | 51157 | Roller presser, complete (replaced by No. 51255) |

Numerical Index

| 341 | 1 | 341 | 2 | 341 | 3 | 341 | 4 | 341 | 5 | 341 | 6 |
|-----|-----------|-----|-----------|-----|----------|-----|----------|-----|----------|-----|----------|
| | Nr. Fig. | | Nr. Fig. | | Nr. Fig. | | Nr. Fig. | | Nr. Fig. | | Nr. Fig. |
| | 19 I | | 152 I | | 366 I | | 568 I | | 1417 IV | | 6525 I |
| | 50 II | | 152 II | | 366 IV | | 568 III | | 1512 II | | 6526 I |
| | + 50 V | | 700152 IV | | 367 IV | | 569 II | | 1522 I | | + 6601 V |
| | 58 II | | 153 IV | | 386 IV | | 570 III | | 1533 IV | | 6623 II |
| | 58 IV | | + 169 V | | 388 I | | 571 III | | 1538 II | | 6759 II |
| | + 58 V | | 172 I | | 390 III | | 624 III | | 1593 II | | 7328 IV |
| | 59 II | | 173 III | | 390 V | | 666 I | | 1809 II | | + 7371 V |
| | 62 I | | + 175 V | | + 398 V | | 672 II | | 1974 II | | 8004 II |
| | 62 IV | | 237 I | | 405 II | | + 672 V | | + 2044 V | | 8005 II |
| | 64 II | | 237 IV | | 406 II | | 680 II | | + 2148 V | | 8008 I |
| | 64 III | | 239 I | | 407 III | | 681 V | | + 2279 V | | 8008 V |
| | 68 III | | 239 III | | + 407 V | | 687 II | | 2504 II | | 8009 I |
| | 70 II | | 243 I | | 410 III | | 687 III | | 2536 IV | | 8009 V |
| | 73 I | | 243 V | | 412 I | | 689 II | | 3100 I | | 8011 I |
| | 73 II | | 257 II | | 422 III | | 689 III | | 4005 I | | 8011 V |
| | 73 III | | 263 III | | 456 II | | 699 I | | 4006 I | | + 8019 V |
| | + 73 V | | 263 IV | | 469 I | | 715 II | | 4531 I | | + 8020 V |
| | 82 I | | 273 IV | | 507 I | | 737 IV | | 5005 IV | | 8021 I |
| | 82 IV | | 700288 I | | + 509 V | | 741 II | | 5068 II | | + 8035 V |
| | + 82 V | | 317 III | | 510 I | | + 785 V | | 5070 II | | 8040 II |
| | 86 III | | 321 II | | 510 II | | + 803 V | | 5125 IV | | 8058 II |
| | 89 I | | 323 II | | 511 II | | 885 II | | 5564 IV | | 8059 II |
| | 89 IV | | 324 V | | 522 II | | 889 IV | | 5565 IV | | 8064 I |
| | 91 II | | 335 IV | | 524 I | | 928 III | | 5567 IV | | 8199 I |
| | 91 IV | | + 336 V | | 529 III | | 928 V | | 5568 IV | | 8281 II |
| | 150 I | | 340 II | | 529 V | | 1032 IV | | 5569 IV | | 8711 I |
| | 150 II | | 359 IV | | 543 V | | 1051 IV | | 5604 II | | 9005 II |
| | 150 III | | 363 IV | | 565 II | | 701319 I | | 6155 II | | 9118 I |
| | 700150 IV | | 364 IV | | 567 III | | 1416 IV | | 6505 I | | 9119 I |

+ = Obsolete Parts

| Numerical Index | | | | | |
|-----------------|-----------|-----------|-----------|-----------|-----------|
| 341 7 | 341 8 | 341 9 | 341 10 | 341 11 | 341 12 |
| Nr. Fig. | Nr. Fig. | Nr. Fig. | Nr. Fig. | Nr. Fig. | Nr. Fig. |
| 9119 V | 9634 II | 10067 II | 10186 I | 11755 V | 13829 III |
| 9302 II | 9635 II | 10079 III | 10195 II | 13503 III | 13831 III |
| 9325 I | 9644 II | 10104 I | 10196 II | 13504 III | 14001 III |
| 9327 II | 9645 II | +10106 V | 10196 IV | 13513 III | 14002 III |
| 9328 I | 9646 II | 10107 I | + 10197 V | 13514 III | 14003 III |
| 9333 II | 9648 II | 10107 IV | + 10200 V | 13518 III | 14004 III |
| 9353 II | 9650 II | 10115 I | + 10201 V | + 13520 V | 14005 III |
| 9354 II | + 9707 V | 10116 I | 710484 I | 13539 III | 14006 III |
| 9355 II | 9715 II | 10127 II | 10617 IV | 13726 II | 14007 III |
| 9365 I | 9811 V | 10128 II | + 10705 V | 13756 III | 14008 III |
| 9367 V | 10001 II | 10129 II | 10728 I | 13757 III | 14010 II |
| 9391 I | 10002 II | 10133 II | 10729 I | 13766 III | 14011 II |
| 9393 I | 10006 I | 10137 I | 10730 I | 13767 III | 14021 III |
| 9394 I | 10006 V | 10157 III | 10731 I | 13769 III | 14024 III |
| 9602 II | 10007 I | 10157 V | 10732 I | 13770 III | 14165 III |
| 9603 II | 10007 V | 10158 III | 10733 IV | 13771 III | 14166 III |
| 9604 II | 10008 I | 10158 V | 10734 I | 13772 V | 14167 III |
| 9605 II | 10009 I | 10159 III | 10737 IV | 13776 III | 14190 III |
| 9606 II | 10014 II | 10159 V | 10809 V | 13778 V | 14192 III |
| 9609 II | 10015 II | 10166 III | 10817 IV | 13779 III | 14200 III |
| 9610 II | 10017 II | 10166 V | 10818 IV | + 13780 V | 14612 III |
| 9612 II | + 10019 V | 10167 III | 10819 IV | + 13781 V | 14675 IV |
| 9616 II | 10022 II | 10167 V | 10820 IV | + 13783 V | 14709 II |
| 9617 II | 10023 I | 10175 I | 10821 IV | 13790 III | 15044 III |
| 9618 II | 10026 I | 10178 III | 10822 IV | 13791 III | 15659 II |
| 9621 II | 10031 II | 10178 V | 10823 I | 13793 III | 15673 IV |
| 9622 II | 10045 II | 10181 I | + 10945 V | 13795 III | 15909 IV |
| 9624 II | 10046 III | 10183 I | + 10963 V | 13819 III | 15910 IV |
| + 9626 V | 10056 III | 10185 I | 11511 III | 13828 III | 15911 IV |

+ = Obsolete Parts

Numerical Index

| 341 13 | 341 14 | 341 15 | 341 16 | 341 17 | 341 18 |
|-----------|-----------|----------|----------|----------|----------|
| Nr. Fig. | Nr. Fig. | Nr. Fig. | Nr. Fig. | Nr. Fig. | Nr. Fig. |
| 15912 IV | 40618 IV | | | | |
| 15913 IV | 40619 IV | | | | |
| 16328 IV | 40621 IV | | | | |
| 17530 IV | 40623 IV | | | | |
| 18358 II | 41063 IV | | | | |
| 18359 II | 41065 IV | | | | |
| 19846 I | 41068 IV | | | | |
| 19853 III | 41076 IV | | | | |
| 23505 I | 41085 IV | | | | |
| 25637 IV | 44618 V | | | | |
| + 25872 V | 44619 V | | | | |
| 25873 V | + 41736 V | | | | |
| 25874 V | 46565 IV | | | | |
| 25976 IV | 46566 IV | | | | |
| 26110 IV | 46567 IV | | | | |
| 26179 IV | 46568 IV | | | | |
| 29093 II | 46569 IV | | | | |
| 29140 II | 46570 IV | | | | |
| 29601 IV | 46571 IV | | | | |
| 30135 IV | 46694 IV | | | | |
| 30246 IV | 46864 I | | | | |
| 30743 IV | + 51157 V | | | | |
| 31251 IV | 51255 V | | | | |
| 31559 IV | 51257 V | | | | |
| 31560 IV | 61005 V | | | | |
| 35461 IV | 105447 I | | | | |
| 40332 III | | | | | |
| 40333 III | | | | | |
| 40349 I | | | | | |

+ = Obsolete Parts



341

Part Number Change

Section

IV/1

To be filed with page: 20

Change No.: T 16585

Date: Nov. 3, 1959

Old Parts

New Parts

19606 Torsion spring
for No. 10737

Remarks:

Please correct the numerical index accordingly.

·Nr. 1/engl

Nr. 1/engl.

From the library of: Superior Sewing Machine & Supply LLC

PFAFF

341

Part Number Change

Section

III/1

To be filed with page:

17

Change No.: T 18023

Date:

June 22, 1960

Old Parts11511 Hook drive shaft
bushing, rear**New Parts**14209 Hook drive shaft
bushing, rear**Remarks:**

No. 11511 can be replaced by No. 14209.

Please correct the numerical index accordingly.

No. 2 / engl.

From the library of: Superior Sewing Machine & Supply LLC

From the library of: Superior Sewing Machine & Supply LLC

PFAFF

341

Part Number Change

Section

IV/2

To be filed with page: 21

Change No.: T 20016

Date: Jul. 26, 1960

Old Parts

New Parts

91 Fastening screw
for No. 10818
10818 Oil pad holder

Remarks:

No. 91 and No. 10818 will no longer be required.

Please correct the numerical index accordingly.

From the library of: Superior Sewing Machine & Supply LLC

PFAFF
341

Part Number Change

Section
III/2

To be filed with page:

17

Change No.: T 16911

Date: Nov. 19, 59

Old Parts

13828 Hook saddle
13829 Hook bearing bushing

New Parts

14714 Hook saddle with
hook bearing bushing

Remarks:

Parts No. 13828 and No. 13829 must be exchanged only as a unit.
Please make the following adjustment under No. 13831, Hook saddle, complete: Cross out Nos. 13828 and 13829 and add No. 14714.

Please correct the numerical index accordingly.

No. 4 / engl.

From the library of: Superior Sewing Machine & Supply LLC

From the library of: Superior Sewing Machine & Supply LLC

PFAFF**Part Number Change**

Section

341

I/1

To be filed with page:

9

Change No.:

T 20529

Date:

Nov. 10, 1960

Old Parts

New Parts

388 Fastening screw
for No. 10115'70000388 Fastening screw
for No. 10115

Remarks:

No. 388 cannot be replaced by No. 70000388.

Please correct the numerical index accordingly.

No. 5 / engl.

From the library of: Superior Sewing Machine & Supply LLC

From the library of: Superior Sewing Machine & Supply LLC

| | | | |
|---|---------------------------|---------------------------------------|-----------------|
| PFAFF 341 | Part Number Change | | Section IV/3 |
| To be filed with page: 21 | Change No.: T 21108 | Date: July 13, 1961 | |
| Old Parts | | New Parts | |
| 19606 Torsion spring for No. 10737 | | 14786 Torsion spring for No. 14675 | |
| Remarks: Part No. 14786 can be replaced by part No. 19606, but the torsion spring should henceforth be attached to No. 14675. Please correct the numerical index accordingly. | | | |

No. 6 / engl.

From the library of: Superior Sewing Machine & Supply LLC

From the library of: Superior Sewing Machine & Supply LLC

| | | | | |
|--|--|--|--|---------------------------|
| PFAFF 341 | | Part Number Change | | SectionIV/4..... |
| To be filed with page: 21 | | Change No.: T 21326 | | Date: Oct. 18, 1961 |
| Old Parts | | New Parts | | |
| | | <u>19677</u> Lifting lever link assembly, complete, consisting of Nos. 263; 367 ; 10617; 14675; 14786 ; 17530 complete; 30246 | | |
| Remarks: An assembly part number has been introduced for the lifting lever link assembly. Please correct the numerical index accordingly. | | | | |

No. 7 / engl.

From the library of: Superior Sewing Machine & Supply LLC

From the library of: Superior Sewing Machine & Supply LLC

PFAFF

341

Part Number Change

Section

II/1

To be filed with page: 13

Change No.: T 21066

Date: 30. 6. 62

Old Parts

10195 Arm shaft bushing, front,
with oil wick No. 10198

New Parts

8003 Arm shaft bushing, front,
with oil pad No. 12199

Remarks:

Part No. 10195 can be replaced by part No. 8003.

Please correct the numerical index accordingly.

No.8/engl.

From the library of: Superior Sewing Machine & Supply LLC

From the library of: Superior Sewing Machine & Supply LLC

PFAFF

341

Part Number ChangeSection
III/3

To be filed with page:

17

Change No.:

1-22500

Date:

Nov. 19, 63

Old Parts

13766 Position bracket for
No. 13828

New Parts

13766 Position bracket, front,
for No. 14714
13723 Position bracket, rear,
for No. 14714
14031 Gasket (rubber) for
Nos. 13518, 13539

Remarks:

Please correct the numerical index accordingly.

No. 9

From the library of: Superior Sewing Machine & Supply LLC

From the library of: Superior Sewing Machine & Supply LLC

| | | | |
|--|---------------------------|---|-----------------|
| PFAFF 341 | Part Number Change | | Section II/2 |
| To be filed with page: 13 | Change No.: AV 52/65 | Date: Nov. 22, 65 | |
| Old Parts | | New Parts | |
| 1974 Positioning pin for No. 9645 | | <u>91-014 710-01</u> Needle bar frame shaft, complete, consisting of Nos. 13-065 199-05; 91-001 809-05; 91-009 644-05; 91-009 645-05; 91-014 709-05 13-065 199-05 Positioning pin for No. 91-009 645-05 | |
| Remarks: Parts Nos. 91-001 809-05; 91-009 644-05; 91-009 645-05 cannot be exchanged singly, but must always be replaced as a unit. Hence, if replacement is required, order assembly No. 91-014 710-01 , complete. | | | |

From the library of: Superior Sewing Machine & Supply LLC



Part Number Change

Section 11/3
341

To be filed with page: 13

Change No.: 1-21 585
1-26 395

Date: Aug. 31, 1967

Old Parts

9715 Arm cover, front

91 Fastening screw
(outside thread dia. = 2.6 mm)
for No. 9715

New Parts

91-010 755-35 Arm cover, front

91-000 089-25 Fastening screw
(outside thread dia. = 3.7 mm)
for No. 91-010 755-35

Remarks: The old parts cannot be replaced by the new ones.

From the library of: Superior Sewing Machine & Supply LLC